

FEATURES

- UCS is 1" deep, designed for T5 lamps
- White acrylic diffuser
- Baked white enamel finish, painted after fabrication
- Damp location standard
- Diffuser easily removable for lamp access and cleaning
- Heavy gauge steel housing
- Optional grounded convenience outlet
- UL listed 1598, cUL or CSA
- Damp Location standard

PROJECT INFORMATION

Project Name _____

Type _____

Catalog No. _____

Date _____

FINISH

Painted parts are treated with a five stage phosphate bonding process and finished with a high reflectance baked white enamel.

CERTIFICATION

All luminaires are built to UL 1598 standards and bear appropriate UL and cUL or CSA labels. Damp location labeling is standard.

ELECTRICAL

Standard class "P", thermally protected, autoresetting HPF ballast, sound rated A. All ballast leads extend a minimum of 6" through access location. NEC/CEC-compliant ballast disconnect is standard.

ORDERING INFORMATION

EXAMPLE UCS12-108-PH120-WSW-GCO

UCS		1		PH		120			
MODEL	SIZE	NO. OF LAMPS IN CROSS SECTION	LAMP TYPE	BALLAST	VOLTAGE	OPTIONS			
UCS Low Profile Undercabinet	12 12" 21 21" 24 24" 33 33" 42 42"	1 One	08 12" or 24", T5: 8 Watt 13 21" or 42", T5: 13 Watt 0813 33", T5: (1) 8 Watt, (1) 13 Watt	PH Preheat	120 120V	WSW On-Off Rocker Switch GCO Grounded Convenience Outlet FCW Cool White Lamp(s) Installed			

Notes:
 Fixtures without switches or Grounded Convenience Outlets (GCO) have knockouts for both for field installation.
 Fixtures with On-Off Rocker Switch (WSW) are equipped with internal starters.
 Ballasts are preheat normal power factor.
 If fixture is to be wired from back or end, order special connector SF1 for Romex, BX or 3/8 Greenfield.
 Fixtures with no switch have internal starters and must be controlled from a wall switch.



PHOTOMETRIC DATA

UCS12

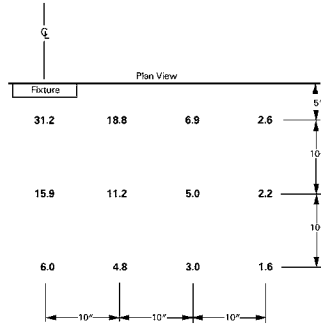
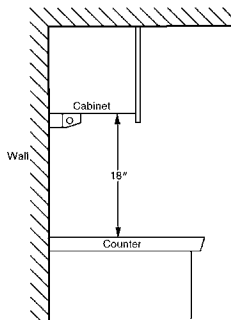

UCS21

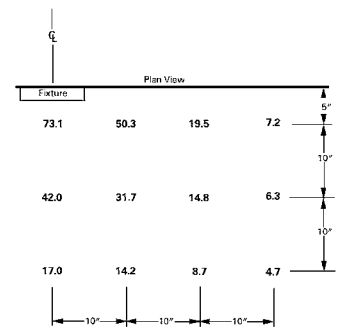
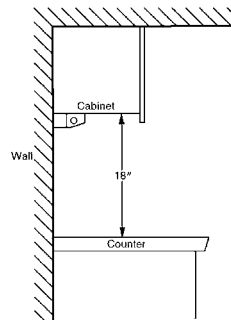

DIMENSIONAL DATA

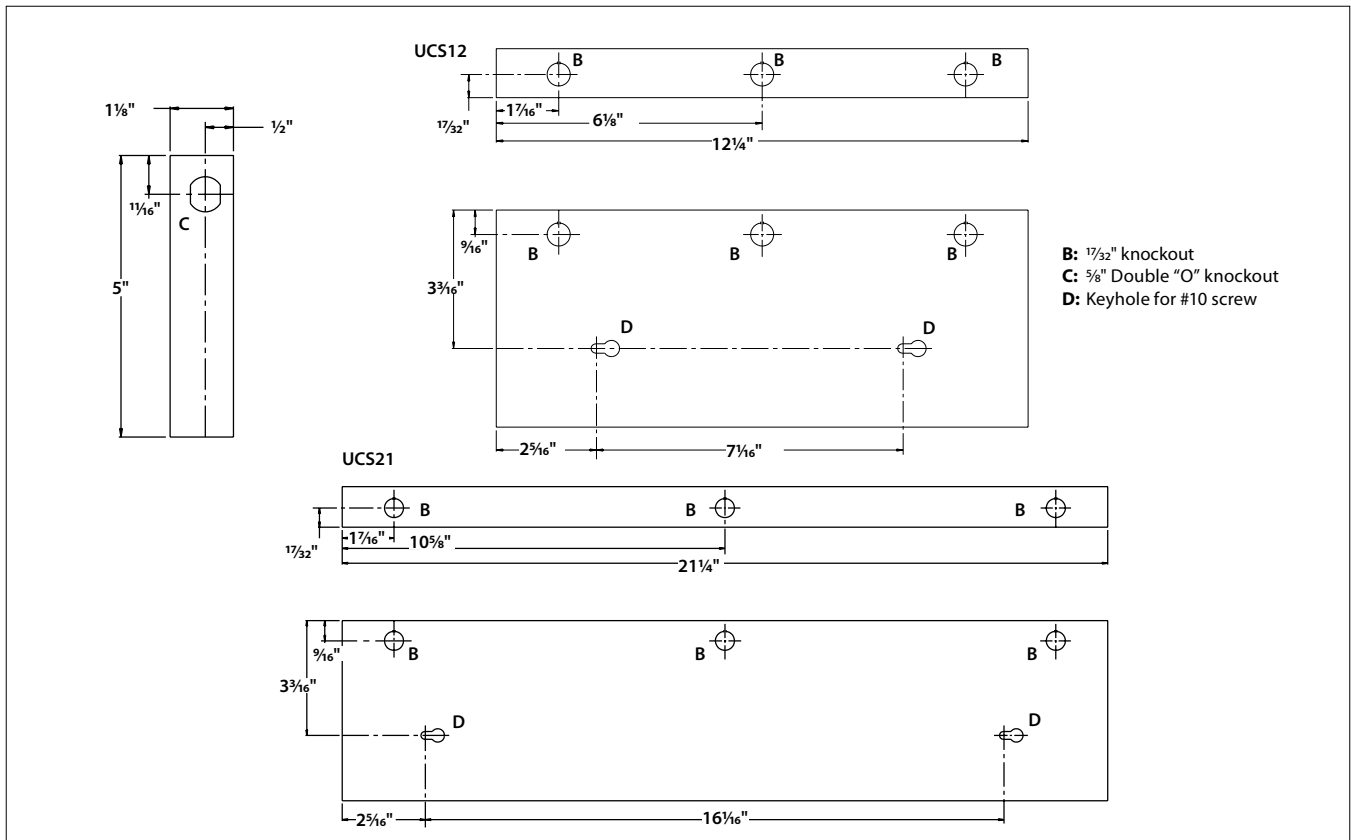

NOTE: All dimensions are in inches; dimensions and specifications are subject to change without notice. Please consult factory or check sample for verification.