

3" Deep Louver

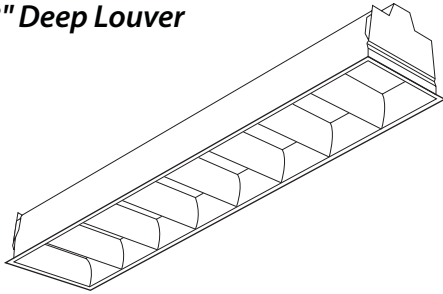

FEATURES

- 3" deep cell louver combined with maximum luminous opening, ideal for retail environments
- Meets IES standard RP-1 glare control
- Ideal for today's electronic office
- Wide light distribution provides uniform illumination
- Utilizes the entire opening of the module to maximize light output
- Anodized aluminum louver, low iridescent available for tri-phosphor lamps
- Surface and pendant mount available

PROJECT INFORMATION

Project Name _____

Type _____

Catalog No. _____

Date _____

CONSTRUCTION

Luminaire housing and end caps are die formed code gauge cold rolled steel. Reflecting surfaces of body and reflector/wireway covers create parabolic contour for precise distribution control. Louver is formed from low iridescent anodized aluminum and is secured by die-formed spring steel hinges. Louver hinges from either side. Mechanical light trap prevents light leaks. Latches are finger-tip actuated, positive feed type.

ELECTRICAL

Standard class "P", thermally protected, autoresetting HPF ballast, sound rated A. CEE NEMA Premium compliant. All ballast leads extend a minimum of 6" through access location. NEC/CEC-compliant ballast disconnect is standard.

FINISH

Painted parts are treated with a five stage phosphate bonding process and finished with a high reflectance baked white enamel.

CEILING COMPATIBILITY

Luminaire is available to fit most standard ceiling types. NEC-compliant T-bar clips supplied with all grid trim fixtures. See ceiling details on reverse. Contact your Columbia representative for compatibility information for specific ceiling types.

AIR HANDLING

Standard luminaire is static. Air extract option available with or without dampers to remove room air and cool lamps.

SURFACE OR PENDANT MOUNT

Companion surface or pendant mount version (SM ceiling type) matches performance and aesthetics of recessed versions.

INSTALLATION

An access plate is furnished with each luminaire for fast wiring access from the plenum. No need to open fixture. Product ships standard with mylar dust cover to eliminate job site contamination.

CERTIFICATION

All luminaires are built to UL 1598 standards and bear appropriate UL and cUL or CSA labels. Damp location labeling is standard. Emergency-equipped fixtures labeled UL 924.

BALLASTS

Energy efficient, thermally protected, automatic resetting, Class P, high power factor, sound rated A, magnetic or electronic ballasts. CEE NEMA Premium compliant.

ORDERING INFORMATION

EXAMPLE P214-154G-LD18-S-EU

P2	14	-	-	1	8	-	-
MODEL	NO. OF LAMPS	CEILING TYPE	NO. CELLS CROSSWISE	NO. CELLS LENGTHWISE	BALLAST	OPTIONS	
P2 High Efficiency Static Parabolic	1 One 2 Two	G Grid F Overlap Flange M Modular Fit-in Trim SM Surface Mount (Static only)	1 One	8 Eight	E Electronic T8, Instant Start EP Electronic T5, T5HO or T8, Programmed Start <small>For a specific ballast vendor, show as option.</small>	F0735 35K 75 CRI T8 Lamps Installed F0835 35K 80 CRI T8 Lamps Installed F5835 35K 80 CRI T5 Lamps Installed GLR Fast Blow Fuse GMF Slow Blow Fuse EL Emergency Battery Pack MS9 Master/Satellite w/9' Harness	
SIZE	LAMP TYPE	LOUVER FINISH	AIR FUNCTIONS		VOLTAGE		
14 1' x 4'	28 4', T5: 28 Watt 32 4', T8: 32, 30, 28 or 25 Watt 54 4', T5HO: 54 or 51 Watt	LD Low Iridescent Semi-Specular (Std.) LS Low Iridescent Specular MA Matte Anodized Low Iridescent Semi-Specular Aluminum	S Static H Heat Extract HD Heat Extract w/Dampers		U 120V-277V 347 347V		

PHOTOMETRIC DATA

Test 10491 Test Date 1/8/03

LUMINAIRE DATA

Luminaire	P214-232G-F518-E P2 Parabolic 1 x 4 2-L Recessed with 1 x 8 Cell Specular Louver
Ballast	B2321120
Ballast Factor	0.96
Lamp	FO32/741
Lumens per Lamp	2850
Watts	59
Shielding Angle	N/A

INDOOR CANDELA PLOT

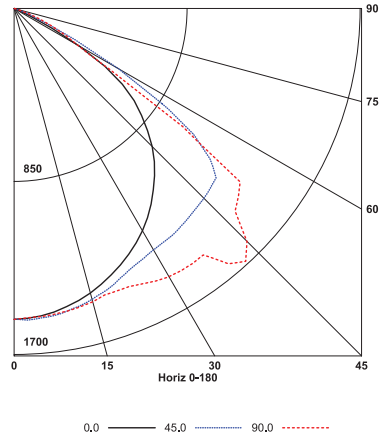

ENERGY DATA

Total Luminaire Efficiency	71.6%
Luminaire Efficacy Rating (LER)	66
ANSI/IESNA RP-1-2004 Compliance	Yes - VDT Normal Use
Comparative Yearly Lighting Energy Cost per 1000 Lumens	\$3.64 based on 3000 hrs. and \$0.08 per KWH

AVG. LUMINANCE (Candela/Sq. M.)

	0.0	22.5	45.0	67.5	90.0
0	4826	4826	4826	4826	4826
30	4602	4697	4996	5405	5551
40	4427	4654	5516	6205	6754
45	4287	4711	5896	7036	7232
50	4017	4829	6368	6633	7071
55	3576	4800	5907	5968	5571
60	2345	3496	3761	2446	2269
65	628	1144	1413	1473	1541
70	83	129	379	656	693
75	49	61	73	85	85
80	36	36	55	55	55
85	0	36	36	36	36

ZONAL LUMEN SUMMARY

Zone	Lumens	% Lamp	% Fixt.
0-30	1212	21.3	29.7
0-40	2061	36.2	50.5
0-60	3866	67.8	94.7
0-90	4081	71.6	100.0
0-180	4081	71.6	100.0

COEFFICIENTS OF UTILIZATION (%)

RCR	RC	80				70				50				0
		70	50	30	10	70	50	30	10	70	50	30	10	0
1	80	77	74	72	78	75	73	71	72	70	69	63	63	
2	73	68	64	61	72	67	63	60	65	61	59	55	55	
3	67	61	56	52	66	60	55	51	58	54	50	47	47	
4	62	54	49	44	60	53	48	44	52	47	43	41	41	
5	57	49	43	38	56	48	42	38	46	41	38	35	35	
6	53	44	38	33	51	43	37	33	42	37	33	31	31	
7	49	40	34	29	48	39	33	29	38	33	29	27	27	
8	45	36	30	26	44	36	30	26	35	30	26	24	24	
9	42	33	27	23	41	33	27	23	32	27	23	22	22	
10	40	30	25	21	39	30	25	21	29	24	21	20	20	

EXTRACT AIR DATA Report AL-462-1.1

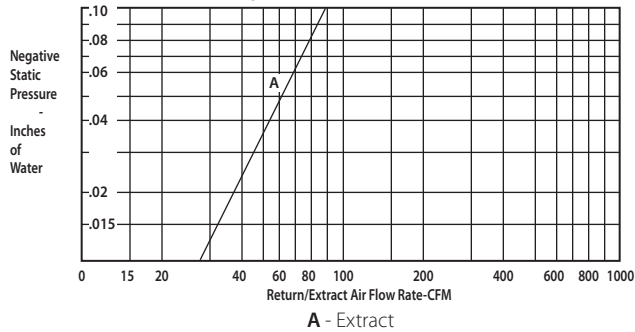

RCR = Room Cavity Ratio

RC = Effective Ceiling Cavity Reflectance RW = Wall Reflectance

DIMENSIONAL DATA

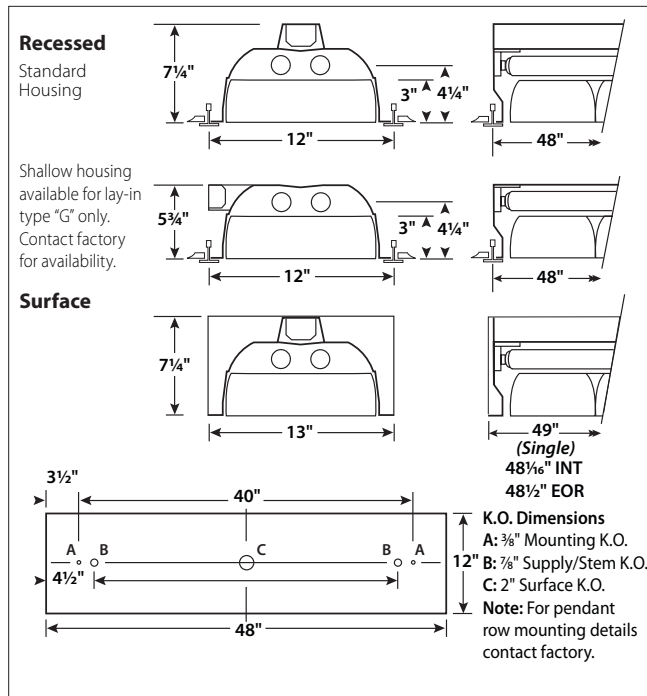

CEILING COMPATIBILITY

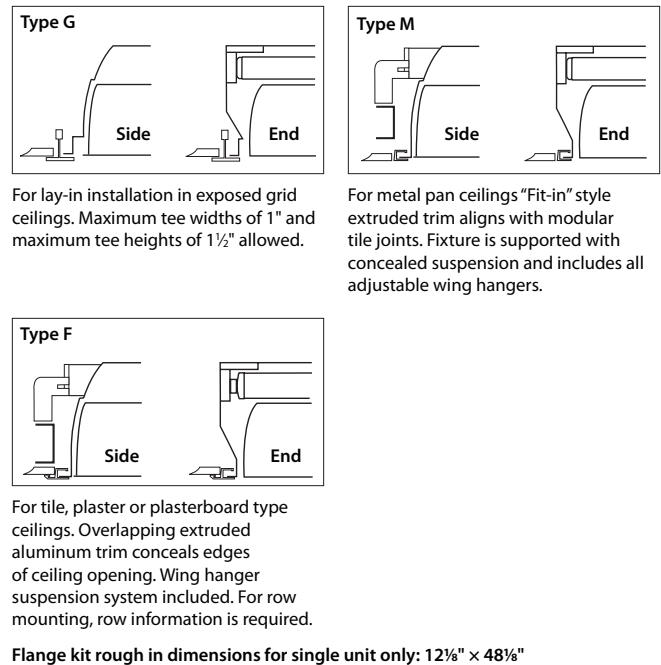

NOTE: All dimensions are in inches; dimensions and specifications are subject to change without notice. Please consult factory or check sample for verification.