

FEATURES

- 6" aperture suits a variety of applications
- Continuous louver provides a sleek, unbroken appearance in row applications
- Available with flush or regressed trim
- One or two-lamp cross sections
- Shielding options include parabolic louver, cross baffle, or lens
- Damp label standard
- NEC/CEC-compliant ballast disconnect standard

PROJECT INFORMATION

Project Name _____

Type _____

Catalog No. _____

Date _____

CONSTRUCTION

Fixture housing is constructed of die formed code gauge steel. Louvers tip into place and are permanently aligned by matching grooves at fixture sides.

FINISH

Painted parts are finished with a high temperature baked white enamel. Louvers are low iridescent semi-specular (diffuse) natural anodized (LD) aluminum as standard.

INSTALLATION

An adapter plate is furnished with each luminaire for fast wiring connections without the necessity of opening the fixture or wireway. A mylar dust cover which eliminates construction dust contamination is standard. Single circuit Tandem wiring is standard for continuous row fixtures. Shielding and hangers required for Type F trim ship separately.

BALLASTS

Energy efficient, thermally protected, automatic resetting, Class P, high power factor, sound rated A, magnetic or electronic ballasts. CEE NEMA Premium compliant.

ELECTRICAL

Standard class "P", thermally protected, autoresetting HPF ballast, sound rated A. CEE NEMA Premium compliant. All ballast leads extend a minimum of 6" through access location. NEC/CEC-compliant ballast disconnect is standard.

CEILING COMPATIBILITY

NP is designed to fit into lay-in (Type G) grid ceilings or concealed suspension (Type F) ceilings requiring an overlapping flange. It is also available in an end-support (Type GT) model which carries the ceiling tile on fixture side tees (see NP-Narrow Parabolic Technical Installation Data). Fixture in exposed grid ceilings (Type G) will have row interrupting cross-tees on 4' centers. For uninterrupted shielding without cross tee use end-of-row and intermediate fixtures.

CORNERS

Continuous shielding illuminated butt joint corners are available for use in 90° patterns. For more information please call your representative or contact the factory.

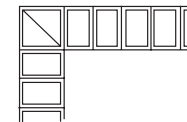

ORDERING INFORMATION

EXAMPLE NP64-232G-FS-LD-EU-SGL

NP											
MODEL	NO. OF LAMPS	CEILING TYPE	SHIELDING	VOLTAGE	OPTIONS	SIZE	LAMP TYPE	TRIM TYPE	BALLAST	ROW CONFIGURATION	
NP Narrow Parabolic	1 One 2 Two	G Grid (For 1" inverted T-bar) F Overlap Flange Trim (For hard ceilings) GT Integral Cross-tee (Grid ends lay into standard T-bar, sides act as integral cross-tee to support tile)	LD Low Iridescent Semi-Specular Parabolic Louver LS Specular Parabolic Louver WCB White Cross Baffle A12 Acrylic Pattern 12 Lens A19 Acrylic Pattern 19 Lens OA Opal Acrylic Lens	U 120V-277V 347 347V	GLR Fast Blow Fuse GMF Slow Blow Fuse EL Emergency Battery Pack NYC NYC Compliant NYCU NYC Compliant, Union Label	62 6" x 2' 63 6" x 3' 64 6" x 4' 66 6" x 6' 68 6" x 8'	17 2', T8: 17 Watt 25 3', T8: 25 Watt 28 4', T5: 28 Watt 32 4', T8: 32, 30, 28 or 25 Watt 54 4', T5HO: 54 or 51 Watt	FS Flush Trim Steel (Grid only) FA Flush Trim RA 1 3/4" Regressed Trim (N/A Grid Trim)	E Electronic T8, Instant Start 3E 3-Lamp Electronic T8, Instant Start 4E 4-Lamp Electronic T8, Instant Start EP Electronic T5 or T8, Programmed Start 3EP 3-Lamp Electronic T5HO or T8, Programmed Start 4EP 4-Lamp Electronic T5HO (N/A 347V) or T8, Programmed Start	SGL Single (Cross tee installations only) EORRH End-of-Row Right Hand* (No cross-tees between housing) EORLH End-of-Row Left Hand* (No cross-tees between housing) INT Intermediate* (No cross-tees between housing)	

*Integral in-row wiring. Single circuit standard.

For a specific ballast vendor show as option.

PHOTOMETRIC DATA

Test 12640 Test Date 1/8/03

LUMINAIRE DATA

Luminaire	NP64-232-FALD-E NP Parabolic 6" x 48" 2-Lamp with 1 x 12 Cell Semi-Specular Louver
Ballast	B2321120RH-A
Ballast Factor	0.88
Lamp	F32T8
Lumens per Lamp	2900
Watts	56
Shielding Angle	0° = 30 90° = 35
Luminous Opening in Feet	Length: 3.87 Width: 0.35 Height: 0.00

ZONAL LUMEN SUMMARY

Zone	Lumens	% Lamp	% Fixt.
0-30	1208	20.8	37.8
0-40	1962	33.8	61.4
0-60	3090	53.3	96.6
0-90	3197	55.1	100.0
0-180	3197	55.1	100.0

ENERGY DATA

Total Luminaire Efficiency	55.1%
Luminaire Efficacy Rating (LER)	50
ANSI/IESNA RP-1-2004 Compliance	Yes - VDT Normal Use
Comparative Yearly Lighting Energy Cost per 1000 Lumens	\$4.80 based on 3000 hrs. and \$0.08 per KWH

COEFFICIENTS OF UTILIZATION (%)

RCR	RC	80				70				50				0				
		RW	70	50	30	10	70	50	30	10	50	30	10	0	50	30	10	0
1	62	60	58	56	60	58	57	55	56	55	54	49						
2	57	54	51	48	56	53	50	48	51	49	47	44						
3	53	48	45	42	52	48	44	42	46	43	41	38						
4	49	44	40	37	48	43	39	36	42	38	36	34						
5	46	40	35	32	45	39	35	32	38	34	32	30						
6	42	36	32	29	41	36	31	29	35	31	28	27						
7	40	33	29	26	39	33	28	26	32	28	25	24						
8	37	30	26	23	36	30	26	23	29	26	23	22						
9	35	28	24	21	34	28	24	21	27	23	21	20						
10	32	26	22	19	32	26	22	19	25	21	19	18						

RCR = Room Cavity Ratio

RC = Effective Ceiling Cavity Reflectance RW = Wall Reflectance

INDOOR CANDELA PLOT

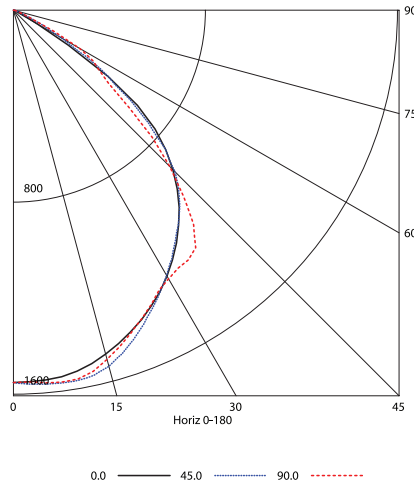

AVG. LUMINANCE (Candela/Sq. M.)

Average Luminance Angle	0.0	22.5	45.0	67.5	90.0
0	12325	12325	12325	12325	12325
30	11736	11957	11709	11764	11856
40	11141	11131	11173	12013	12117
45	10553	10429	10699	10407	10351
50	9520	9186	9136	8234	7715
55	6678	6983	6692	5764	6027
60	1860	3052	3671	4355	5038
65	790	809	1523	1805	1523
70	511	488	534	674	674
75	368	338	338	399	399
80	275	275	229	275	275
85	182	182	182	182	182

DIMENSIONAL DATA

Type G Lay-in exposed grid. Fits standard 1" wide, 1 1/2" tall tee.

Flush Trim

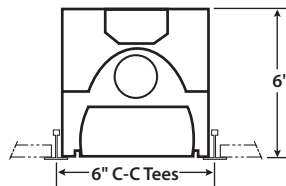

Regressed Trim

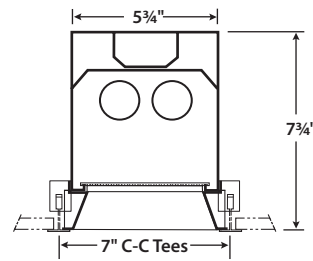

Type F For hard ceiling applications. Yoke hangers are shipped separately. Carrier channel by others.

Flush Flange

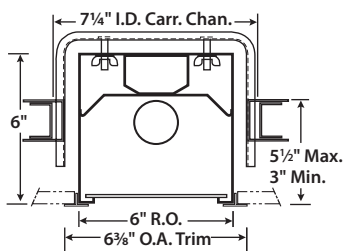

Regressed Flange

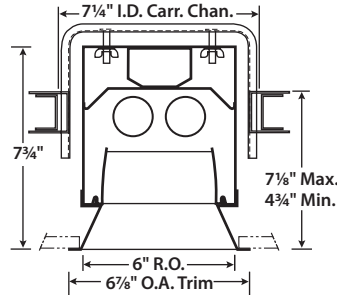

Type GT Integral cross-tee (grid ends lay into standard T-bar, sides act as integral cross-tee to support tile). Fits standard 1" wide, 1 1/2" tall tee. Cut ceiling tile into two 8 7/8" strips.

End View

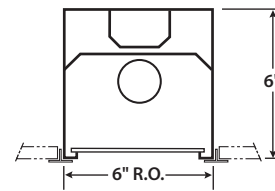

Side View

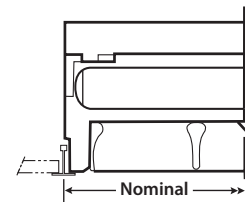

NOTE: All dimensions are in inches; dimensions and specifications are subject to change without notice. Please consult factory or check sample for verification.